

Soils Map

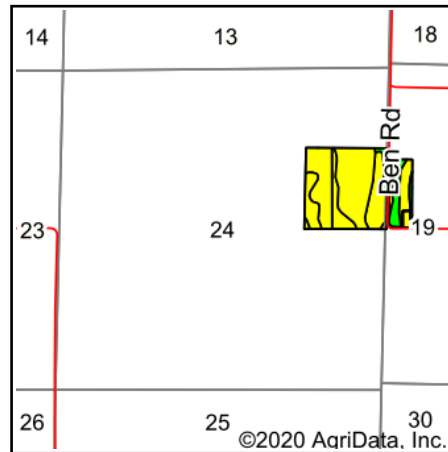

Soils data provided by USDA and NRCS.



State: **Illinois**
 County: **Saline**
 Location: **24-9S-6E**
 Township: **Harrisburg**
 Acres: **52**
 Date: **10/1/2020**



Maps Provided By:



© AgriData, Inc. 2020

www.AgriDataInc.com

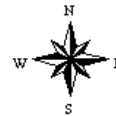

Area Symbol: IL165, Soil Area Version: 15					
Code	Soil Description	Acres	Percent of field	Il. State Productivity Index Legend	Crop productivity index for optimum management
338A	Hurst silt loam, 0 to 2 percent slopes	21.48	41.3%		100
3071A	Darwin silty clay, 0 to 2 percent slopes, frequently flooded	15.88	30.5%		111
**482B	Uniontown silt loam, 2 to 6 percent slopes	4.50	8.7%		**116
**122B	Colp silt loam, 2 to 5 percent slopes	3.94	7.6%		**97
723A	Reesville silt loam, 0 to 2 percent slopes	3.90	7.5%		124
142A	Patton silty clay loam, 0 to 2 percent slopes	2.30	4.4%		132
Weighted Average					107.7

Table: Optimum Crop Productivity Ratings for Illinois Soil by K.R. Olson and J.M. Lang, Office of Research, ACES, University of Illinois at Champaign-Urbana. Version: 1/2/2012 Amended Table S2 B811

Crop yields and productivity indices for optimum management (B811) are maintained at the following NRES web site: <http://soilproductivity.nres.illinois.edu/>

** Indexes adjusted for slope and erosion according to Bulletin 811 Table S3

*c: Using Capabilities Class Dominant Condition Aggregation Method

Soils data provided by USDA and NRCS. Soils data provided by University of Illinois at Champaign-Urbana.